

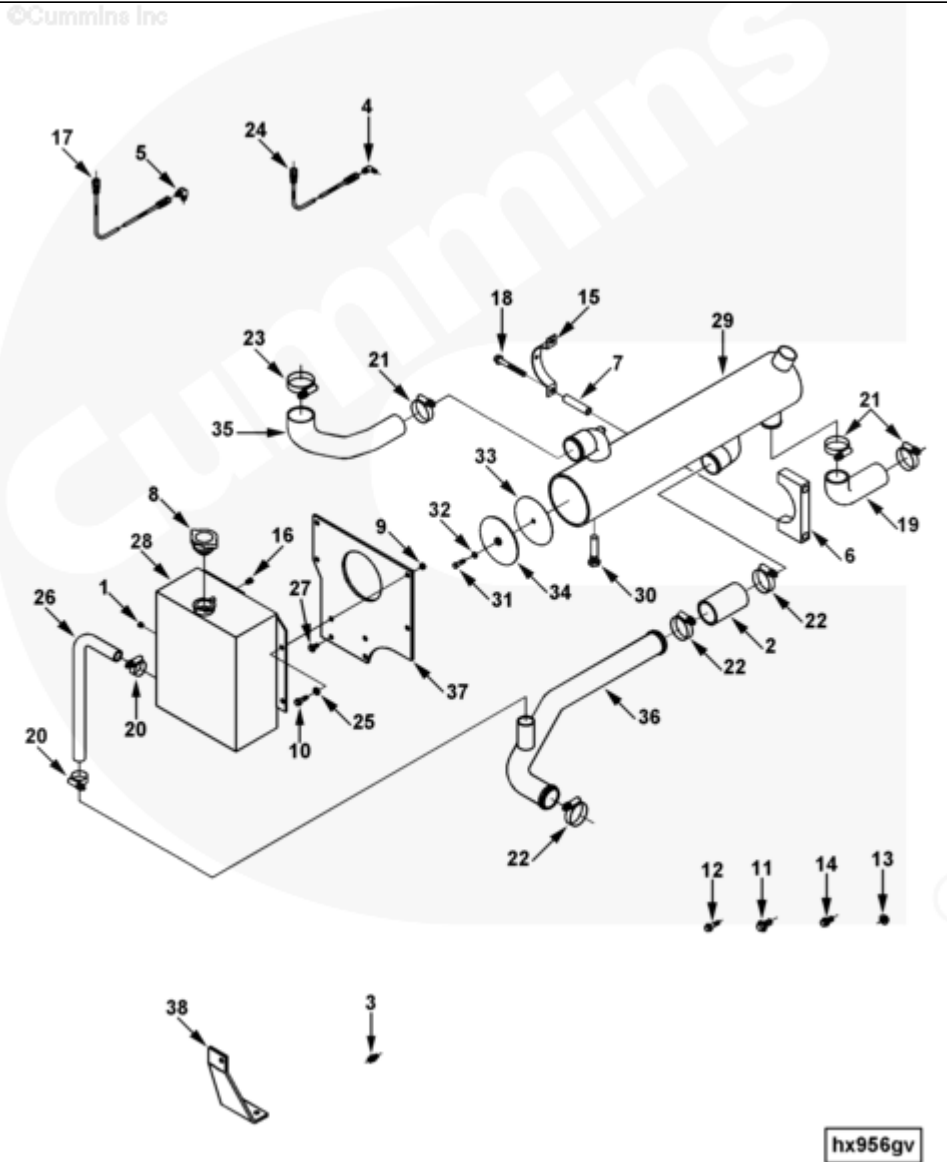

# Parts Catalog - Option Detail

Electronic Parts Catalog - Option Detail				
Option	Group	Graphic	Film Card	Date
HX9105-01	08.10	hx956gv	Z	21-JUN-01
<b>Engines</b>	6C8.3, C GAS PLUS CM556, G8.3, G8.3 CM558, GTA8.3 CM558, ISC CM2150, ISC CM554, ISC CM850, ISC8.3 CM2250, ISC8.3 G CM2180 C101, ISL CM2150, ISL CM554, ISL CM850, ISL G CM2180, ISL8.9 CM2150 L110, ISL8.9 CM2880 L112, ISL9 CM2150 SN, ISL9 CM2250, ISL9 CM2350 L101, ISL9 CM2350 L111, ISLE4 CM850, L GAS PLUS CM556, L8.9, L8.9 L121, L8.9G CMOH2.0 L125B, L9 CM2350 L116B, L9 CM2350 L119B, L9 CM2350 L120C, L9 CM2350 L123B, L9.3 L105, L9.5 L117, L9N CM2380 L124B, QSC8.3 CM2250, QSC8.3 CM2880 C102, QSC8.3 CM554, QSC8.3 CM850(CM2850), QSL9 CM2250, QSL9 CM2250 L115, QSL9 CM2350 L102, QSL9 CM2350 L107, QSL9 CM2350 L118, QSL9 CM2350 L122, QSL9 CM554, QSL9 CM850(CM2850), QSL9 G CM558, QSL9 M CM2250 L106, QSL9.3 CM2880 L113			



Cart	Ref No	Part Number	Part Description	Required	Remarks
<a href="#">View My Cart</a>					
		<a href="#">HX9105-01</a>	Heat Exchanger		<a href="#">MR - EXCHANGER, HEAT...(More)</a>
					Turbo Location: Mid-Block
					Application: Marine
					Exchangers Coolant Source:
					Sea Water
					Engine Cylinders: 6
					Parts Provided in Kit: No
					Exhaust Manifold Location:
					Top
					Plumbed To Water Inlet: Yes
					Coolant Package Type:
					Water-Water
					Maximum Sea Water Inlet
					Temp (deg F): 95
<input type="checkbox"/>	1	<a href="#">S 910 B</a>	Pipe Plug	1	1/4 NPT.
<input type="checkbox"/>	2	<a href="#">63241 N</a>	Plain Hose	1	
<input type="checkbox"/>	3	<a href="#">68138</a>	Male Connector	1	1/8 NPTF x 7/16-20
<input type="checkbox"/>	4	<a href="#">68139</a>	Male Adapter Elbow	1	1/8 NPTF X 7/16 - 20 (90).
<input type="checkbox"/>	5	<a href="#">112105</a>	Male Adapter Elbow	1	
<input type="checkbox"/>		<a href="#">3281793</a>	Vibration Isolator	2	
	6	<a href="#">3281791</a>	Vibration Isolator	1	
	7	<a href="#">3281792</a>	Mounting Spacer	1	
<input type="checkbox"/>	8	<a href="#">3393978</a>	Filler Cap	1	
<input type="checkbox"/>	9	<a href="#">3900240</a>	Regular Hexagon Nut	4	M8 X 1.25.
<input type="checkbox"/>	10	<a href="#">3900631</a>	Hexagon Flange Head Cap Screw	3	M8 X 1.25 X 25.
<input type="checkbox"/>	11	<a href="#">3901249</a>	Hexagon Flange Head Cap Screw	2	M12 X 1.75 X 25.
<input type="checkbox"/>	12	<a href="#">3902114</a>	Hexagon Flange Head Cap Screw	1	M8 X 1.25 X 30.

<input type="checkbox"/>	13	<a href="#">3902662</a>	Hexagon Flange Nut	1	M10 x 1.50
<input type="checkbox"/>	14	<a href="#">3903990</a>	Hexagon Flange Head Cap Screw	2	M10 X 1.50 X 20.
<input type="checkbox"/>	15	<a href="#">3905057</a>	Retaining Clamp	2	
<input type="checkbox"/>	16	<a href="#">3906619</a>	Pipe Plug	3	1/8 NPT.
<input type="checkbox"/>	17	<a href="#">3906747</a>	Flexible Hose	1	Oil Supply Line
<input type="checkbox"/>	18	<a href="#">3908226</a>	Hexagon Flange Head Cap Screw	4	M10 X 1.50 X 95.
<input type="checkbox"/>	19	<a href="#">3912177</a>	Elbow Hose	1	
<input type="checkbox"/>	20	<a href="#">3922842</a>	Hose Clamp	2	
<input type="checkbox"/>	21	<a href="#">3922846</a>	Hose Clamp	3	
<input type="checkbox"/>	22	<a href="#">3922847</a>	Hose Clamp	3	
<input type="checkbox"/>	23	<a href="#">3922849</a>	Hose Clamp	1	
<input type="checkbox"/>	24	<a href="#">3924054</a>	Flexible Hose	1	
<input type="checkbox"/>	25	<a href="#">3924348</a>	Plain Washer	4	
<input type="checkbox"/>	26	<a href="#">3924849</a>	Plain Hose	1	
<input type="checkbox"/>	27	<a href="#">3925883</a>	Hexagon Flange Head Cap Screw	4	M8 X 1.25 X 16
<input type="checkbox"/>	28	<a href="#">3971620</a>	Expansion Tank	1	
<input type="checkbox"/>	29	<a href="#">4019855</a>	Heat Exchanger	1	
<input type="checkbox"/>	30	<a href="#">3970463</a>	Zinc Electrode Plug	1	
<input type="checkbox"/>	31	<a href="#">3975185</a>	Hexagon Head Cap Screw	2	
<input type="checkbox"/>	32	<a href="#">3975186</a>	Sealing Washer	2	
<input type="checkbox"/>	33	<a href="#">3975187</a>	Heat Exchanger Gasket	2	
<input type="checkbox"/>	34	<a href="#">3975189</a>	Heat Exchanger Cover	2	
<input type="checkbox"/>	35	<a href="#">4019915</a>	Molded Hose	1	
<input type="checkbox"/>	36	<a href="#">4020192</a>	Water Transfer Tube	1	
<input type="checkbox"/>	37	<a href="#">4058321</a>	Expansion Tank Bracket	1	
<input type="checkbox"/>	38	<a href="#">4058322</a>	Expansion Tank Brace	1	